

PURE FICTION

June 10 – July 22, 2016

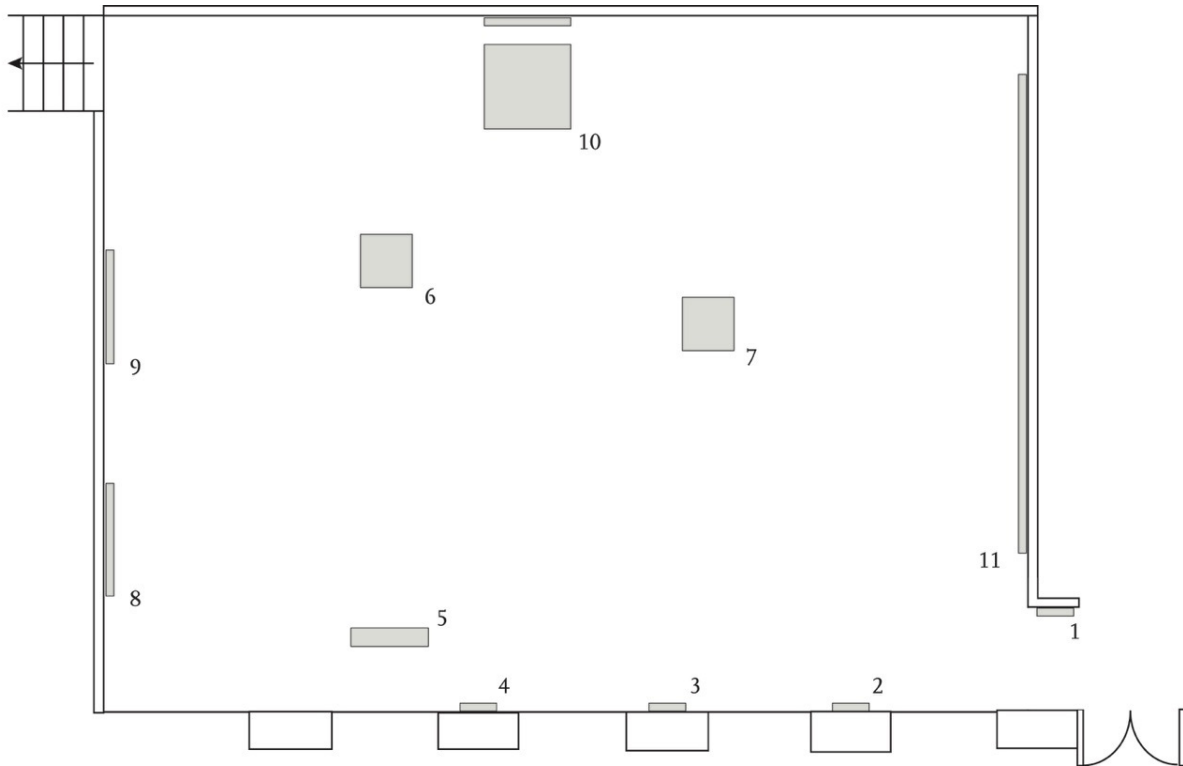

1. ROBERT FILLIOU

The, A Novel, Robert Filliou, ca. 1976
2 cardboard boxes, wire and pastel
25 13/16 x 15 11/16 x 5 7/8 in. (65.6 x 40 x 15 cm)

2. HENRI MICHAUX

Untitled, 1981
Watercolor on paper
12 3/16 x 9 7/16 in. (31 x 24 cm)

3. WIN MCCARTHY

"always these few raindrops and / never the storm. / always a partial view" (Winnie's View 28 - 30), 2015
Glass, pipefitting, transparency, tape
16 x 6 x 3 in. (40.6 x 15.2 x 7.6 cm)

4. MARCEL BROODTHAERS

Le Motif, 1973
Pencil, pastel on canvas
16 x 12 3/4 x 1 3/4 in. (40.64 x 32.39 x 4.45 cm)

5. MICHAEL DEAN

X (Working Title), 2015
Concrete
67 11/16 x 18 7/8 x 16 1/2 in. (172 x 48 x 42 cm)

6. MICHAEL DEAN

X (Working Title), 2015
Concrete
67 11/16 x 18 7/8 x 16 1/2 in. (172 x 48 x 42 cm)

7. MICHAEL DEAN

Analogue X, 2015
Concrete, tree straps, book pages, book
66 1/8 x 39 5/16 x 22 7/16 in. (168 x 100 x 57 cm)

8. PIERRE KLOSSOWSKI

Ogier morigénant le Frère Damiens, 1990
Colored pencil on paper
68 7/8 x 55 7/8 in. (175 x 142 cm)

9. PIERRE KLOSSOWSKI

Auberge de la comète II, 1984
Colored pencil on paper
42 1/2 x 53 1/2 in. (108 x 136 cm)

10. MARCEL BROODTHAERS

Furniture Marie Püch, 1967/1968
Installation, mixed media, children's chair, foot stool, wooden blocks
Photo Canvas: 41 1/2 x 51 1/8 x 7/8" (105.4 x 129.9 x 2.2 cm)
Chair: 21 x 16 x 14 in. (53.3 x 40.6 x 35.6 cm)
Stool: 9 1/2 x 11 7/8 x 7 7/8 in. (24.1 x 30.2 x 20 cm)
Blocks 1: 9 7/16 x 3 7/8 x 5 7/8 in. (24 x 10 x 15 cm)

11. ROBERT FILLIOU

Input/Output Analysis, 1973
Photographs on seven chipboard panels
59 1/16 x 59 1/16 in. (150 x 150 cm) (each)

GALERIE MARIAN GOODMAN

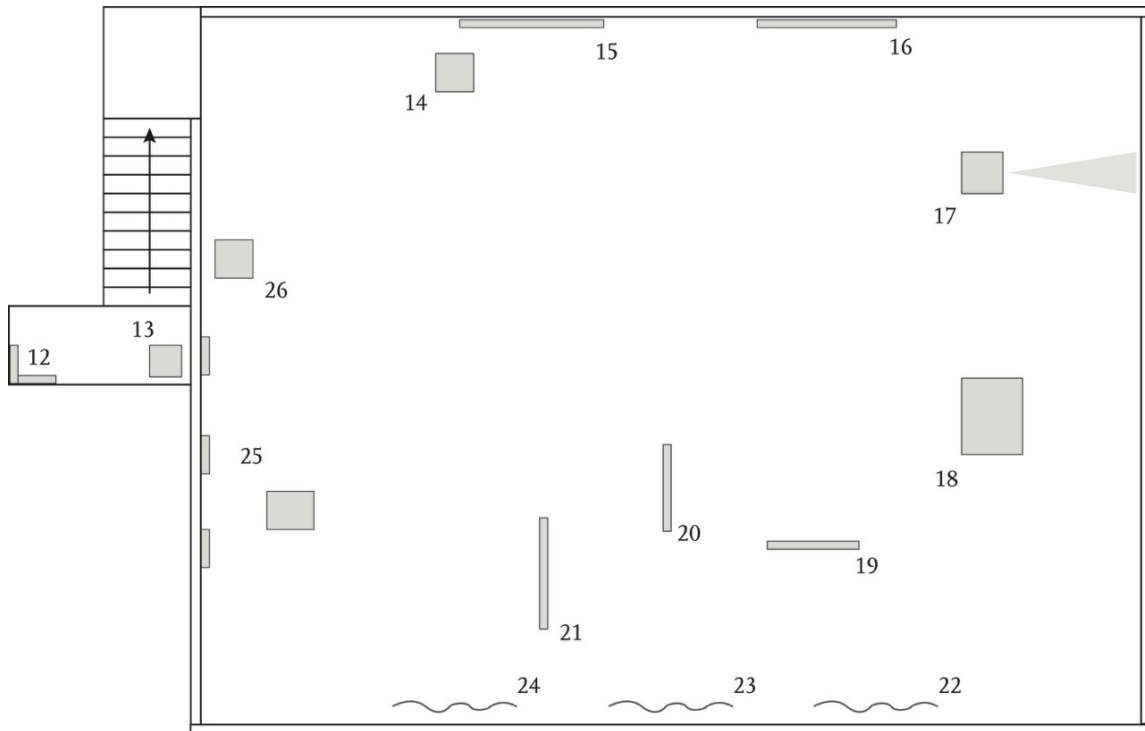

12. BUNNY ROGERS

Study for Joan Portrait, 2016
Set of 5 fine art prints on Hahnemuhle Photorag Ultrasmooth 305gr, artist frame
Frame: 14 x 12 x 1 in. (36 x 31 x 3 cm)(each)
Edition of 3

13. BUNNY ROGERS

Petrified Stump (Black), 2016
Ceramic, ribbon
13.5 x 14 in. diameter (34.3 x 35.6 cm)

Jodie Doll (Blue), 2016

Cotton, polyester, stuffing, thread, yarn
approximately: 26 1/2 x 17 x 2 1/2 in. (67.3 x 6 11/16 x 6.4 cm)

Cunny Poe Vol.1, 2014

Book, pressed Columbine flowers, "Clone High" rose printed satin ribbon bookmark, patches
8 1/2 x 6 1/2 x 1 in. (21.6 x 16.5 x 2.5 cm)

14. BUNNY ROGERS

Petrified Stump (Lavender), 2016
Ceramic, ribbon
13.5 x 14 in. diameter (34.3 x 35.6 cm)

15. ED ATKINS

Untitled 6, 2014
Acrylic, silkscreen and ink on board
96 1/16 x 48 in. (244 x 122 cm)

16. ED ATKINS

Untitled 3, 2014
Acrylic, silkscreen, ink and collage on board
96 1/16 x 48 in. (244 x 122 cm)

17. GIUSEPPE PENONE

To reverse one's eyes (Rovesciare i propri occhi), 1970
Slide projection, 7 slides
Edition of 5

18. GIUSEPPE PENONE

Cocci, 1979
3 parts; plaster and terracotta
56 1/2 x 23 5/8 x 15 3/4 in. (143.5 x 60 x 40 cm)

19. LILI REYNAUD-DEWAR

Safe Space, 2016
Digital print on cotton duffel on metal stand
70 13/16 x 27 1/2 x 19 5/8 in. (180 x 70 x 50 cm)

20. LILI REYNAUD-DEWAR

Safe Space, 2016
Digital print on cotton duffel on metal stand
70 13/16 x 41 11/16 x 19 5/8 in. (180 x 106 x 50 cm)

21. LILI REYNAUD-DEWAR

Safe Space, 2016
Digital print on cotton duffel on metal stand
70 13/16 x 51 1/8 x 19 5/8 in. (180 x 130 x 50 cm)

22. LILI REYNAUD-DEWAR

My epidemic (a body as public as a book can be), 2015
Fabric, ink, steel
137 3/4 x 64 9/16 in. (350 x 164 cm)

23. LILI REYNAUD-DEWAR

My epidemic (a body as public as a book can be), 2015
Fabric, ink, steel
137 3/4 x 54 5/16 in. (350 x 138 cm)

24. LILI REYNAUD-DEWAR

My epidemic (a body as public as a book can be), 2015
Fabric, ink, steel
137 3/4 x 54 5/16 in. (350 x 138 cm)

25. JOSEF STRAU

Line, 2016
Tin wire, pencil on canvas, posters
23 9/16 x 19 5/8 x 3/4 in. (60 x 50 x 2 cm)

Flower, 2016

Tin wire, pencil on canvas, posters
19 5/8 x 23 9/16 x 3/4 in. (50 x 60 x 2 cm)

Wave, 2016

Tin wire, pencil on canvas, posters
19 5/8 x 23 9/16 x 3/4 in. (50 x 60 x 2 cm)

26. BUNNY ROGERS

Jodie Doll (Red), 2016
Cotton, polyester, stuffing, thread, yarn
approximately: 26 1/2 x 17 x 2 1/2 in. (67.3 x 6 11/16 x 6.4 cm)

Jodie Doll (Yellow), 2016

Cotton, polyester, stuffing, thread, yarn
approximately: 26 1/2 x 17 x 2 1/2 in. (67.3 x 6 11/16 x 6.4 cm)