

# MARIAN GOODMAN GALLERY

## SCULPTURE 4TET LUCIANO FABRO, JEAN-LUC MOULÈNE, BRUCE NAUMAN AND DANH VÕ

Marian Goodman Gallery, London  
12 January – 20 February 2016

### Reception Gallery



BRUCE NAUMAN  
*Tone Mirror*, 1975  
Colour lithograph  
76 x 101.6 x 2 cm  
Edition of 100  
No. 0330

### Lower Main Gallery Clockwise from entrance



LUCIANO FABRO  
*Sisifo – A (onice)*, 1994  
Onyx and flour  
97.2 x 58.6 x 58.6 cm  
Dimensions variable  
No. 16757



LUCIANO FABRO  
*Ogni ordine è contemporaneo d'ogni altro ordine: quattro modi d'esaminare la facciata del SS. Redentore a Venezia (Palladio) (Every order is contemporaneous with every other order. Four ways of studying the facade of the Church of the Holy Redeemer in Venice (Palladio))*, 1972  
51 sheets; silkscreen on paper  
213.7 x 254 cm, 213.8 x 253.3 cm,  
279.6 x 242.2 cm, 233 x 242.5 cm  
Edition of 120  
No. 16801



LUCIANO FABRO  
*Nudo (Prigione)*, 1987  
Red Verona marble  
181 x 46.6 x 15.5 cm  
No. 17629



JEAN-LUC MOULÈNE  
*Gymnaste, Paris, summer 2013, 2013*  
Steel, foam, wood, epoxy, plaster  
140 x 72 x 90 cm  
NO. 17583



LUCIANO FABRO  
*Nudo (Prigione)*, 1987  
Bardiglio marble  
173 x 44.8 x 15.3 cm  
No. 17630



JEAN-LUC MOULÈNE  
*Nu, 29 juillet 2011*  
*Avec Marion Romagnon, Paris 2011, 2011*  
Cibachrome on aluminium  
126 x 183 x 6 cm  
Edition of 3  
NO.17585



LUCIANO FABRO  
*Italia All'asta*, 1994  
Iron sheet and green varnish  
335.5 x 71.2 x 9.5 cm  
Edition of 6  
No. 17631

# MARIAN GOODMAN GALLERY



JEAN-LUC MOULÈNE  
*Untitled (Ox lungs)*, 2014  
Waxed, polished concrete, steel and acrylic blanket  
28 x 31 x 82 cm  
No. 17584



JEAN-LUC MOULÈNE  
*Janus, Paris*, 2014, 2014  
Concrete, iron, wood  
166 x 90 x 50 cm  
No. 17606



JEAN-LUC MOULÈNE  
*4tet*, 2012  
Silicone and silver leaf  
48 x 45 cm  
No. 17739



BRUCE NAUMAN  
*Life and Death*, 1983  
Neon  
157 x 157 x 20 cm  
No. 17472

## Terrace Gallery



BRUCE NAUMAN  
*Welcome to L.A.*, 1985  
Graphite, watercolour and  
acrylic on paper  
198 x 178 cm  
No.17632

## Lower Side Gallery



BRUCE NAUMAN  
*Shit in your Hat - Head on a Chair*, 1990  
Wood, wax, screen and video installation  
Duration: 62 minutes 25 seconds  
Dimensions variable  
No. 17473  
Loan courtesy of "la Caixa" Collection of  
Contemporary Art

# MARIAN GOODMAN GALLERY

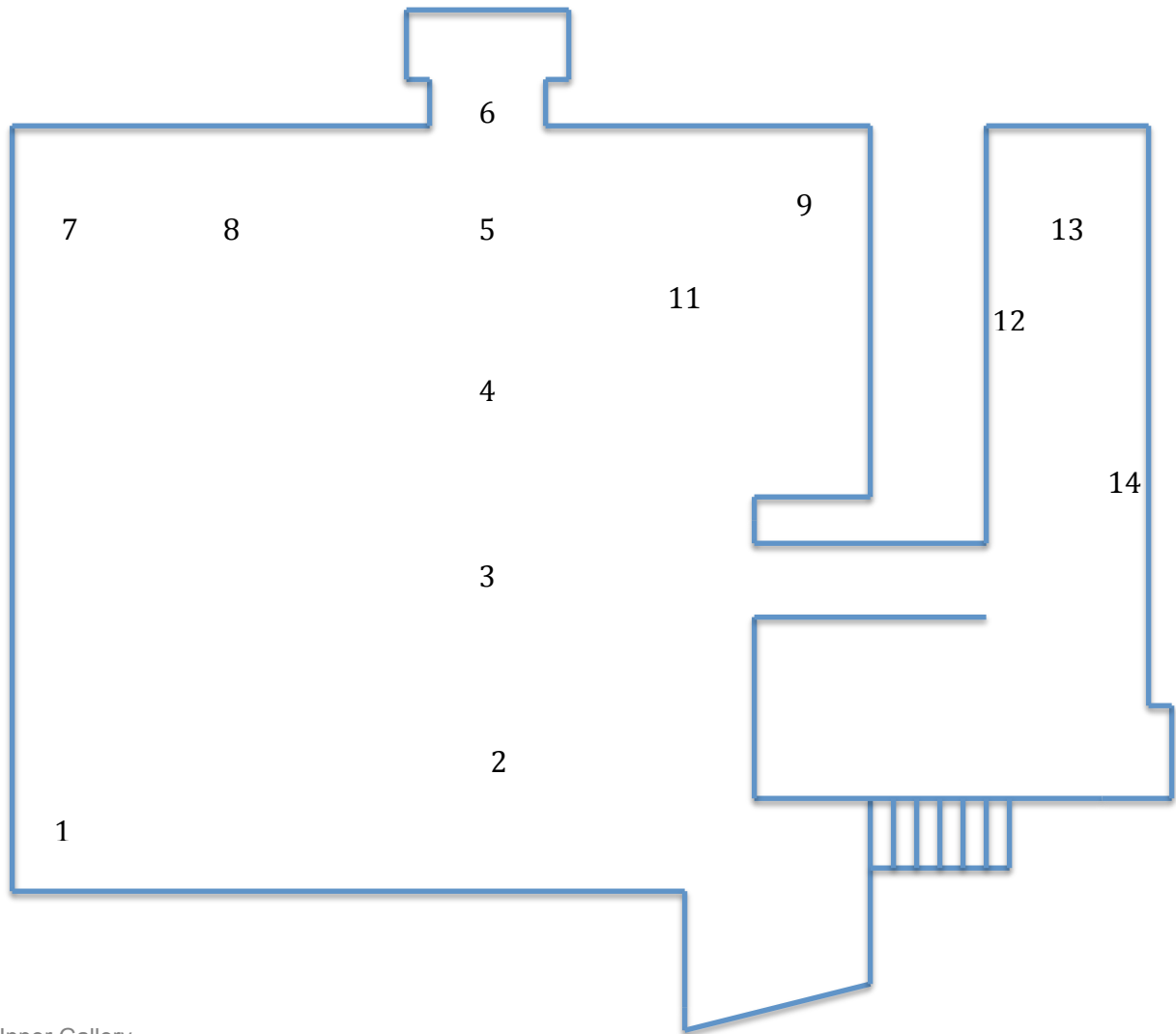

## Upper Gallery

1. JEAN-LUC MOULÈNE  
*Tronche: Skull, Paris, 2014, 2014*  
Polished concrete and blanket  
30 x 20 x 25 cm  
No. 17594

2. JEAN-LUC MOULÈNE  
*Tronche: The Mask, Paris, 2014, 2014*  
Polished concrete and blanket  
26 x 18 x 26 cm  
No. 17593

3. JEAN-LUC MOULÈNE  
*Tronche: John Kerry, Paris, 2014, 2014*  
Polished concrete and blanket  
27 x 25 x 28 cm  
No. 17589

4. JEAN-LUC MOULÈNE  
*Tronche: The Thing, Paris, 2014, 2014*  
Polished concrete and blanket  
26 x 18 x 26 cm  
No. 17592

5. JEAN-LUC MOULÈNE  
*Tronche: Carlos Salinas de Gortari, Paris, 2014, 2014*  
Polished concrete and blanket  
28 x 26 x 24 cm  
No. 17591

# MARIAN GOODMAN GALLERY

## 6. JEAN-LUC MOULÈNE

*Tronche: Cowardly Lion, Paris, 2014, 2014*

Polished concrete and blanket

34 x 33 x 33 cm

No. 17586

## 7. JEAN-LUC MOULÈNE

*Tronche: Enrique Peña Nieto, Paris, 2014, 2014*

Polished concrete and blanket

26 x 23 x 27 cm

No. 17597

## 8. JEAN-LUC MOULÈNE

*Tronche: Barack Obama, Paris, 2014, 2014*

Polished concrete and blanket

28 x 24 x 28 cm

No. 17588

## 9. JEAN-LUC MOULÈNE

*Tronche: Mitt Romney, Paris, 2014, 2014*

Polished concrete and blanket

29 x 21 x 28 cm

No. 17590

## 10. JEAN-LUC MOULÈNE

*Tronche: Babu Mafflu, Paris, 2014, 2014*

Polished concrete and blanket

36 x 22 x 28 cm

No. 17587

## 11. JEAN-LUC MOULÈNE

*Knot-Knot, 2012*

Steel, bronze

126 x 98 x 98 cm

No. 17595

## Upper Side Gallery

## 12. DANH VÕ

*Do you know what she did, your cuntling daughter?*

2015

Glass mirror, engraving by Phung Võ

75 x 90 cm

No. 17644

## 14. DANH VÕ

*03.06.1965, 2015*

Photogravure on Somerset 300 gr. paper

59.5 x 57 cm

Edition of 24

No. 17003

## 13. DANH VÕ

*Ο Θεόσμαύρο, 2015*

White crystalline Greek-marble sarcophagus fragment from Rome, end of second century AD;

The Virgin of the Annunciation carved from poplar wood with traces of polychrome,

Italy, School of Nino

Pisano, c. 1350

177.5 x 57 x 52 cm

No. 17596